

Signs

SIGN FEATURES



Unbreakable Sign Face

Faces are formed from solar grade co-extruded polycarbonate

to resist damage from impact and yellowing due to sunlight.

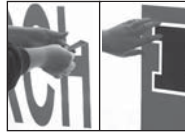

Second Surface Decoration

3M™ high performance vinyl is applied second surface (inside the face) protected both from vandals and the elements.

Fiberglass Decorative Trim

Gives a smooth, three-dimensional finished look.

Not available in all sizes.



Graffiti-Resistant Paint

Paint is baked on at 180°; graffiti can easily be wiped away.



Locking Vandal Cover

A keyed locking vandal cover system keeps vandals from getting access to the message.



Easy Copy Changes

Self-supporting mechanical props, support the vandal cover opening to 90° for ease of message changes.

Planked Face

Planking in the face adds rigidity to keep the face from sagging and allows air, water and debris to flow through.



Riveted Copy Track

Rivets hold stronger than glue and in combination with the planking allow for easy cleaning.



Strong Structure

Engineered for 120 mph windloads to accommodate zoning regulations.

